

Wireless Remote Control System for Air Balancing Damper Adjustments

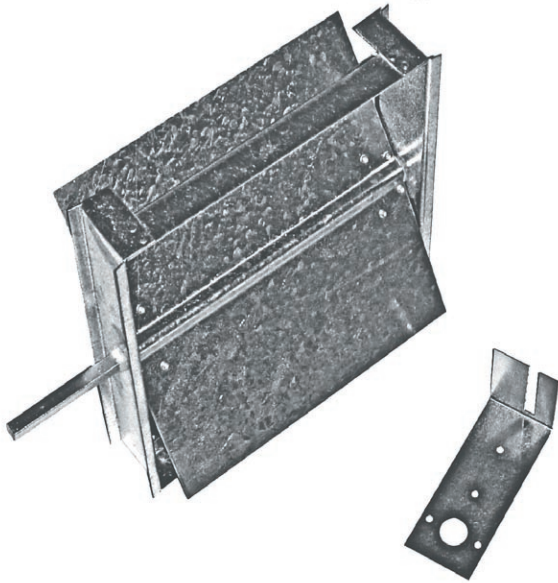

The Series ZTR Single Blade Damper

The ZTR dampers install easily in rigid duct sections and are designed for air flow control, not tight shutoff.

The anti-rotation bracket is shipped loose for field mounting. The bracket design allows the ZSA-I actuator to mount against the duct or up to two inches above it when external duct wrap, is used, without the need for a standoff bracket.

The Series ZTR standard construction:

Frame: 18 gauge galvanized, 2" x 3/8" "U" channel for rigidity.

Optional aluminum frame and blade.

Blade: 18 gauge with "V" groove across the center for added rigidity.

Shaft: 3/8 inch square galvanized.

Bearings: Molded nylon insert.

Available sizes: 4 x 4 through 24 x 18.

The frame is 1/8 inch under listed size for easy install in rigid duct.

Other configurations of the single blade balancing damper . . .

Bellmouth, inline, straight sided and 45° takeoffs; 4" – 20"

26 gauge galvanized; 3/8" shaft with molded nylon bearings

Flanged frame with or without "peel-and-stick" mounting.

Shown at the right with the ZSA-I actuator.

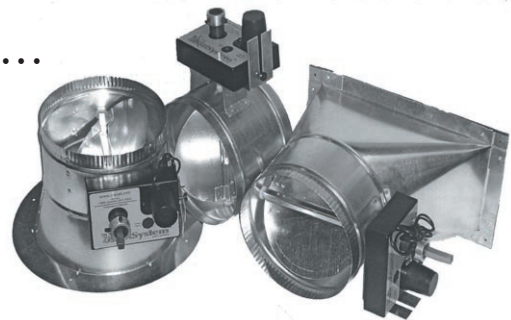

Even a well-designed HVAC system may perform poorly and waste energy if not properly balanced. The Zipset System's unique approach to the air balancing task offers a quick, precise, and economical solution.

The Zipset System is a product of The Zip Group, LLC

www.zipset.net zipset@zipset.net 888-zipset4U (947-7384) 888-237-2343 f

2711 Centerville Road Suite 120-6370 Wilmington, DE 19808